

# Installation Instructions for Motorizing AR or AW Backdraft Dampers

## Single Panel Backdraft Dampers

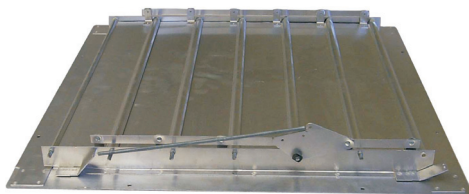

Step 1

1. Remove all Springs supplied on the unmotorized version and discard.



Step 2

2. Flatten the spring tab to the position shown.



Step 3

3. Mark the locations of the (3) holes in the motor base on the flange using the motor base as a template.

Drill 1 1/64" (.172) diameter hole at each of the positions marked.

Mount the motor bracket to the damper using three No. 8 sheet metal screws.

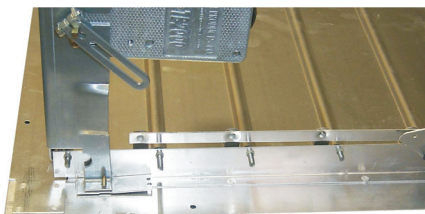

Step 4

4. Attach the motor to the motor base as shown using four 5/32" x 3/8" bolts. Tighten bolts. Position the motor arm as shown.

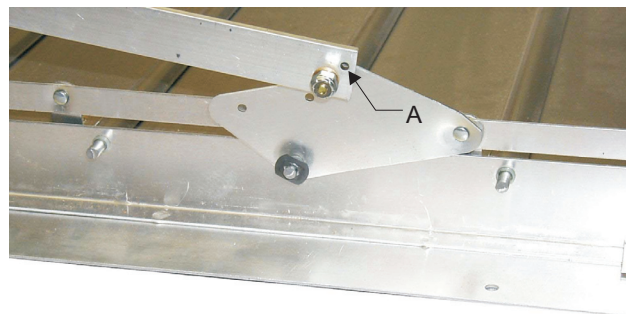

Step 5

5. Attach the linkage bar to the linkage bracket in the following sequence: bolt, linkage bracket, washer, brass bushing, linkage bar, washer and lock nut then tighten. See sequence in Step 6.

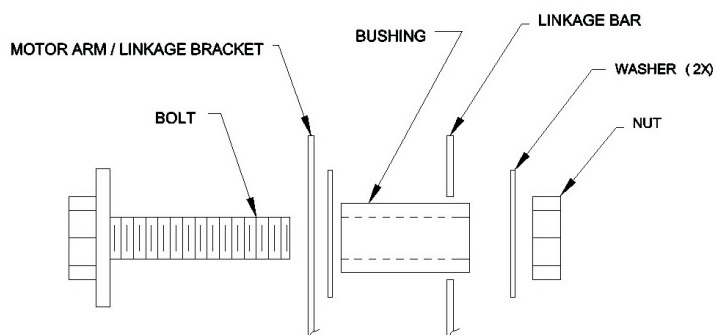

Step 6

6. Attach the linkage bar to motor arm using same sequence as in Step 5 and tighten.

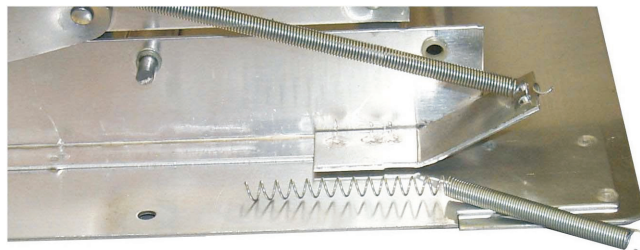

Step 7

7. Attach the spring, supplied in the motorizing kit, to the Linkage Bar Hole A (Step 5) and the spring tab opposite the motor as shown.

Stretch and cut the spring 1" longer than the distance between Linkage Bar and Spring Tab.

## Double Panel Backdraft Dampers

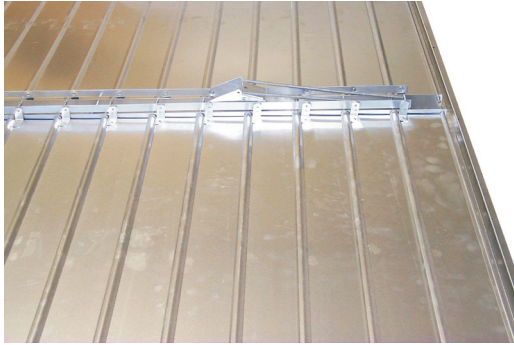

Step 1

1. Remove all springs supplied on the unmotorized version and discard. Flatten the spring tab.

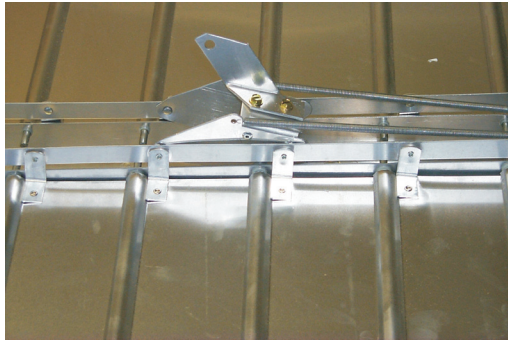

Step 2

2. For old style retrofit use this bracket.



Step 3

3. Drill required 2 holes and bolt. Then follow remaining steps.

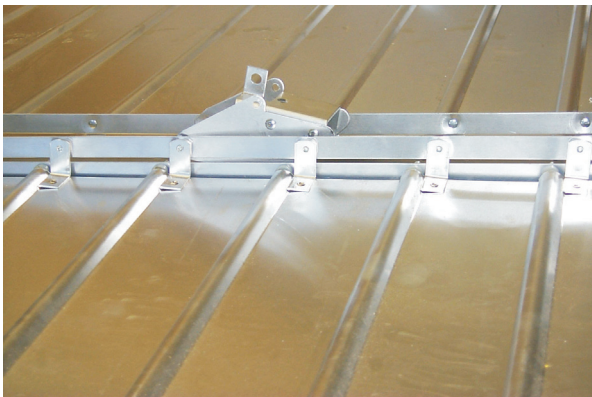

Step 4

4. New style linkage bracket.

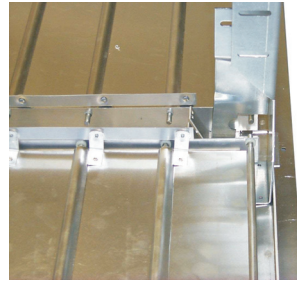

Step 5

5. Mark the locations of the (3) holes in the motor base on the flange using the motor base as a template.

Drill 1 1/64" (.172) diameter hole at each of the positions marked.

Mount the motor bracket to the damper using three No. 8 sheet metal screws.



Step 6

6. Attach the motor to the motor base as shown using four 5/32" x 3/8" bolts. Tighten bolts. Position the motor arm as shown.

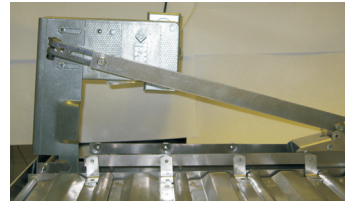

Step 7

7. Attach the linkage bar to the linkage bracket in the following sequence: bolt, linkage bracket, washer, brass bushing, linkage bar, washer and lock nut then tighten. See sequence.

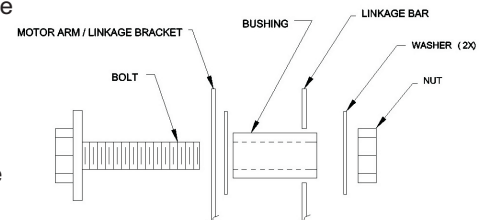

Attach the linkage bar to motor arm using same sequence and tighten.

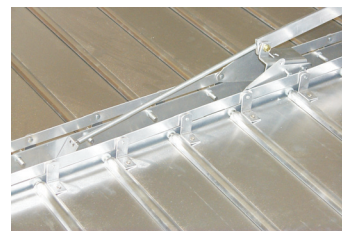

Step 8

8. Attach the spring, supplied in the motorizing kit, to the Linkage Bar Hole A (Single Panel Step 5) and the spring tab opposite the motor as shown.